

# The Stratford



lenker.



First Floor 2,096<sup>±</sup> sf - Bonus Room 368<sup>±</sup> sf - Front Porch 77<sup>±</sup> sf - Rear Porch 63<sup>±</sup> sf  
Garage 628<sup>±</sup> sf - **Total 3,232<sup>±</sup> sf** | 3-4 Bedrooms | 2 full / 2 half Bathrooms



All information contained herein is deemed reliable but not guaranteed. All illustrations are artist's depictions only and are not meant to be exact and do not show accurate details as they will appear on the finished product. House orientation is determined by builder. All dimensions are approximate only and may differ from the actual home. No part of this brochure constitutes an agreement of any kind between Epic Homes and you. Elevations & floorplans may be shown with optional upgrades.



# The Stratford



## 2nd Floor

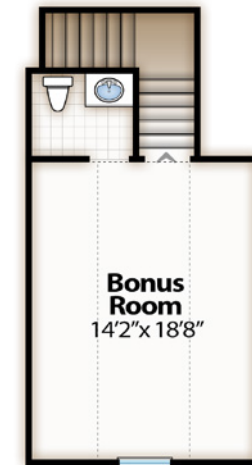

Call 803-900-EPIC for more information, or visit us online at [www.epichomesllc.net](http://www.epichomesllc.net).



All information contained herein is deemed reliable but not guaranteed. All illustrations are artist's depictions only and are not meant to be exact and do not show accurate details as they will appear on the finished product. House orientation is determined by builder. All dimensions are approximate only and may differ from the actual home. No part of this brochure constitutes an agreement of any kind between Epic Homes and you. Elevations & floorplans may be shown with optional upgrades.

